

FIRM INTRODUCTION

Our Story



G. Holmes Bell, IV, PE
CEO & Chairman

For more than six decades, we at Hussey Gay Bell have remained steadfast in our commitment to providing an enduring legacy of excellence in design and service in the fields of engineering, architecture and surveying.

Our dedication to the firm's core values of innovation, initiation of ideas and collaboration are exemplified through our intense focus on client relations and production of award-winning work. Yet, the true essence of Hussey Gay Bell's strength lies within the talented group of professionals who work tirelessly on our clients' behalf. We at Hussey Gay Bell understand our duty to perform at the highest levels of standards, both professionally and civically, to enhance the quality of life within all of the communities we serve as evidenced by our established history of involvement with civic and charitable organizations and service leadership on industry and community boards. This commitment to excellence extends to every client and to every community we serve. So, here's to the next 60 years.

Firm History



Our Founders Left to Right:
Mr. DeYoung, Mr. Gay, Mr. Bell, Mr. Hussey

<div>1958</div> <div>Founded & Incorporated Civil Engineering Firm In Savannah, GA</div>	<div>1966</div> <div>Gus H. Bell, III, PE Joins Firm</div>	<div>1979</div> <div>Firm Expands with Architecture Studio</div>	<div>1986</div> <div>Gus H. Bell, III, PE Becomes Chairman & CEO</div>
<div>1987</div> <div>Firm Expands to Columbia, SC</div>	<div>1989</div> <div>Firm Expands to Charleston, SC</div>	<div>1994</div> <div>G. Holmes Bell, IV, PE Joins Firm</div>	<div>2012</div> <div>G. Holmes Bell, IV, PE Becomes 3rd Chairman & CEO</div>
<div>2014</div> <div>Firm Moves From Gainesville to Metro Atlanta, GA</div>	<div>2017</div> <div>Firm Expands to Statesboro, GA & Nashville, TN</div>	<div>2018</div> <div>Firm Celebrates 60 Years</div>	<div>2022</div> <div>Firm Acquires Atlanta-Based Hayes James & Opens Greenville, SC, Grows The Family</div>

Firm Overview



1958

Year of Founding

68

Years in Business

8

Regional Offices

175+

Professionals

12

In-House Disciplines

2025

ENR Top 500 Design Firm

Services

Architecture
Interior Design
Civil Engineering
Transportation Systems Engineering
Water & Wastewater Engineering
Natural Gas Systems Engineering
Environmental Engineering
Structural Engineering
Landscape Architecture
Surveying
Permitting
Construction Management Services

Markets

Commercial
Education
Government
Healthcare
Industrial
Residential
Transportation
Water



Breadth of Related Experience

175+
projects

18
public school
districts

60+
years of design
experience

8
independent
schools

Contractor Relationships





EXPERTISE



Humanities at Juliette Gordon Low Elementary School
Savannah-Chatham County Public School System
Savannah, GA

Completion Date: 2017
Size: 127,855 SF
Construction Cost: \$24.1M
Services: Architecture, Interiors, Civil & Structural









Otis J. Brock, III Elementary School
 Savannah-Chatham County Public School System
 Savannah, GA

Completion Date: 2016
 Size: 96,000 SF
 Construction Cost: \$18M
 Services: Architecture, Interiors, Civil & Structural





Meadowcreek Cluster Elementary School
Gwinnett County Public Schools
Tucker, GA

Completion Date: 2018
Size: 207,616 SF
Construction Cost: \$31M
Services: Architecture & Interiors



Coleman STEAM Middle School Renovation
Gwinnett County Public Schools
Duluth, GA

Completion Date: 2018
Size: 123,200 SF
Construction Cost: \$5.1M (renovations); \$2.4M (roof & HVAC renovation)
Services: Architecture & Interiors





Meadow Glen Middle School
Lexington County School District One
Lexington County, SC

Completion Date: 2012
Size: 180,000 SF
Construction Cost: \$30.6M
Services: Architecture, Interiors & Civil





Camp Road Middle School
Charleston County School District
Charleston, SC

Completion Date: 2020
Size: 137,000 SF
Construction Cost: \$52M
Services: Civil Engineering



Langston Chapel Middle School & William James
Middle School Athletic Facilities
Bulloch County Schools
Statesboro, GA

Completion Date: 2022
Size: 25 acres + 37 acres
Construction Cost: \$5.5M
Services: Architecture, Civil & Surveying



Herschel V. Jenkins High School
Savannah-Chatham County Public School System
Savannah, GA

Completion Date: 2022
Size: 241,651 SF
Construction Cost: \$58M
Services: Architecture, Interiors, Civil, Structural, Surveying

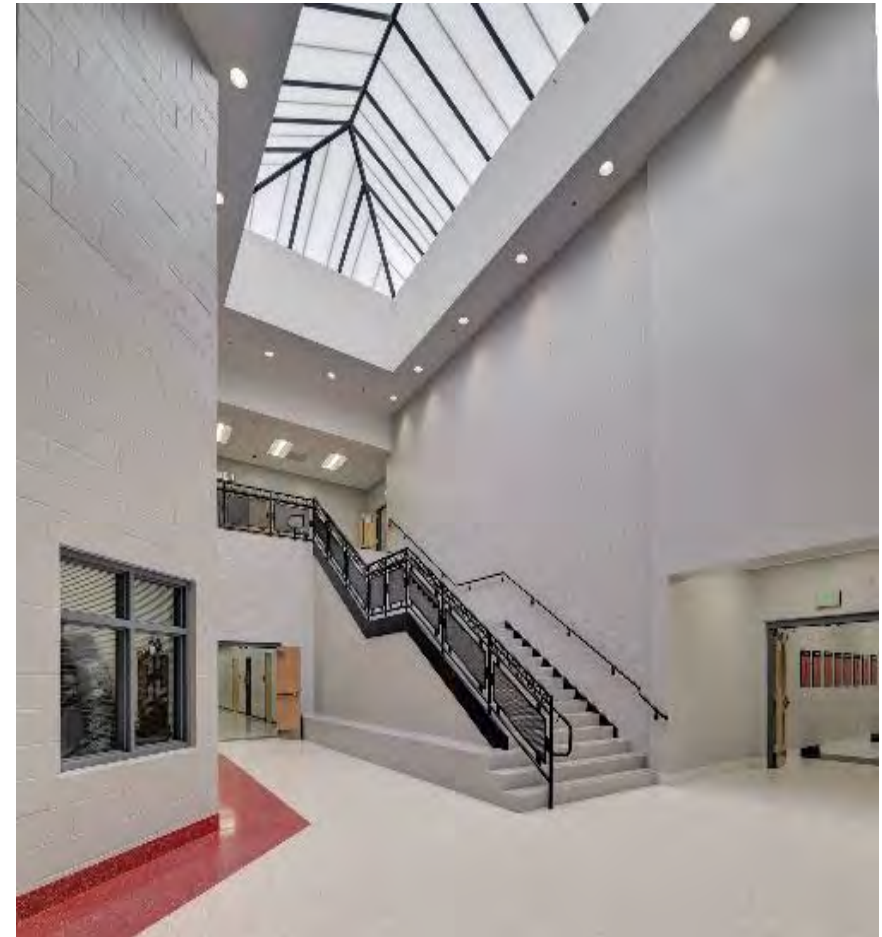





Mingledorff Hall Upper School STEM Center
Savannah Country Day School
Savannah, GA

Completion Date: 2022
Size: 32,000 SF
Construction Cost: \$12.6M
Services: Architecture, Civil, Structural & Surveying



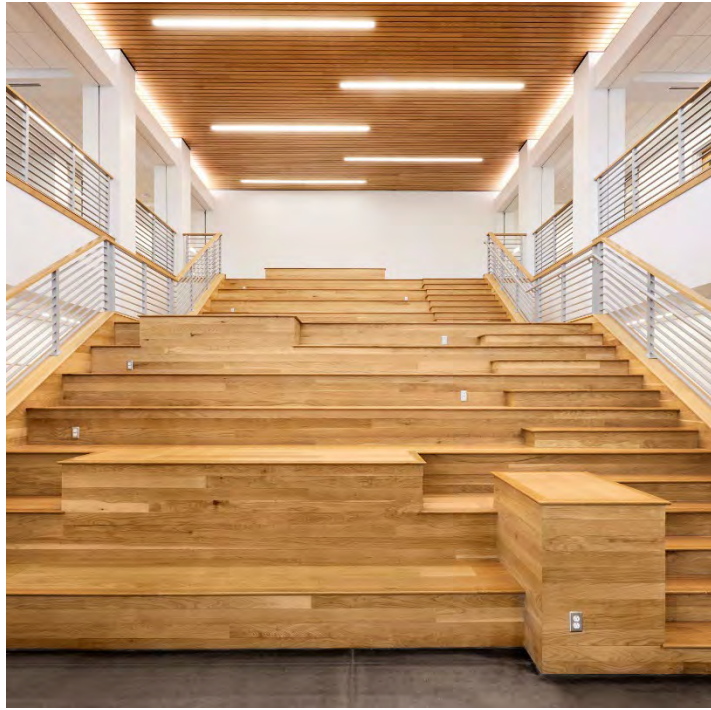



Windsor Forest High School
Savannah-Chatham County Public School System
Savannah, GA

Completion Date: 2025
Size: 202,000 SF
Construction Cost: \$83M
Services: Architecture, Interiors, Civil & Structural





Gwinnett School of Math, Science & Technology
Gwinnett County Public Schools
Lawrenceville, GA

Completion Date: 2010
Size: 260,000 SF (new) / 100,000 SF (renovated)
Construction Cost: \$35M
Services: Architecture & Interiors



East Hall High School Expansion
& Renovation
Hall County School District
Hall County, GA

Completion Date: 2024
Size: 125,000 SF
Construction Cost: \$32M
Services: Architecture, Interiors
& Civil



East Hall High School Expansion & Renovation
Hall County School District
Hall County, GA

Completion Date: 2024
Size: 125,000 SF
Construction Cost: \$32M
Services: Architecture, Interiors & Civil





Cedar Grove High School Auditorium
DeKalb County School District
Ellenwood, GA

Completion Date: 2023
Size: 21,800 SF
Construction Cost: \$11M
Services: Architecture & Interiors



Alfred Ely Beach High School Softball &
Baseball Fields
Savannah-Chatham County Public School System
Savannah, GA

Completion Date: 2017
Size: 10.9 acres
Construction Cost: \$1.8M
Services: Civil & Surveying



Wando High School
Charleston County School District
Mt. Pleasant, SC

Completion Date: 2003
Size: 433,121 SF
Construction Cost: \$60M
Services: Civil Engineering



District 2 Athletic Stadium
Charleston County School District
Mt. Pleasant, SC

Completion Date: 2018
Size: 7 acres
Construction Cost: \$16.5M
Services: Civil Engineering



Whale Branch Early College High School
Beaufort County School District
Seabrook, SC

Completion Date: 2010
Size: 180,000 SF
Construction Cost: \$28.7M
Services: Architecture



